

A PART OF THE NORTHWEST 1/4 OF SECTION 36, T-2-N, R-5-E,  
GENOA TOWNSHIP, LIVINGSTON COUNTY, MICHIGAN

NORTH 1/4 COR.  
OF SECTION 36  
T-2-N, R-5-E  
L.C.R.C. L.S.C. 1358



POINT OF BEGINNING

SCALE: 1" = 3000'

POINT OF BEGINNING

ARC = 194.46', RAD = 413.00'  
DELTA = 26°58'41"  
CHD. = S 53°27'45" W, 192.67'

ARC = 35.36', RAD = 526.00'  
DELTA = 03°51'05"  
CHD. = S 65°01'33" W, 35.35'

22

ARC= 138.10', RAD.= 526.00'  
DELTA = 15°02'36"  
CHD.= S 55°34'43" W, 137.71'

MEANDER CORNER

MEANDER CORNER  
L.C.R.C. L.S.C. 1688

N 88°11'50"E  
130.20'

CENTER OF  
SECTION 36  
T-2-N, R-5-E  
(NOT SET IN LAKE

1. ALL DIMENSIONS ARE GIVEN IN FEET.
2. CURVILINEAR MEASUREMENTS ARE ARC DISTANCES.
3. CONCRETE MONUMENTS HAVE BEEN PLACED AT ALL POINTS MARKED "o".
4. CONCRETE MONUMENTS ARE STEEL BARS ONE-HALF (1/2) INCH IN DIAMETER AND THIRTY SIX (36) INCHES IN LENGTH, ENCASED IN A CONCRETE CYLINDER FOUR (4) INCHES IN DIAMETER, AND THIRTY SIX (36) INCHES IN LENGTH.
5. LOT CORNERS HAVE BEEN MARKED WITH STEEL BARS ONE-HALF (1/2) INCH IN DIAMETER, AND EIGHTEEN (18) INCHES IN LENGTH.
6. (R)= RADIAL LINE, (NR) = NON RADIAL LINE  
L INDICATES A RIGHT ANGLE.
7. BEARINGS ARE IN RELATION TO THE TRUE MERIDIAN, AS DETERMINED BY POLARIS OBSERVATION, DATE 11/13/1984.
9. ■ DENOTES FOUND MONUMENT 1/2 INCH STEEL BAR ENCASED IN 4 INCHES DIAMETER CONCRETE.

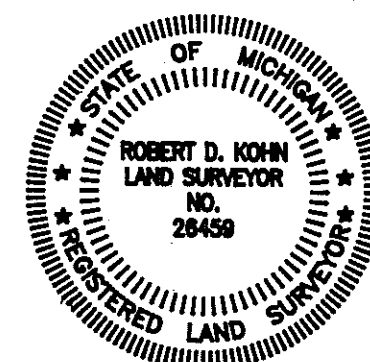

Robert D. Hohn

**Giffels-Webster Engineers Inc.**  
ENGINEERS - SURVEYORS - PLANNERS  
2871 BOND STREET ROCHESTER HILLS MICHIGAN  
(810) 852-3100

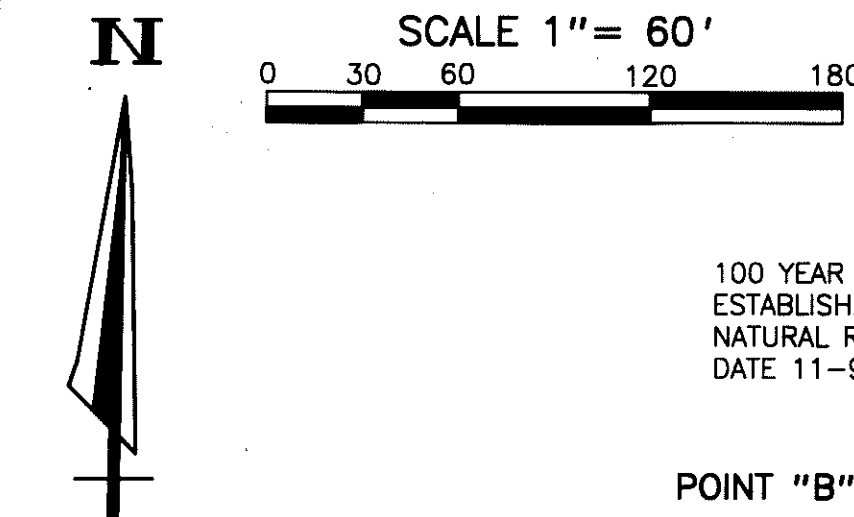

100 YEAR FLOODPLAIN CONTOUR AS  
ESTABLISHED BY THE DEPARTMENT OF  
NATURAL RESOURCES N. G. V. DATUM.  
DATE 11-9-89

THIS PLAT IS SUBJECT TO RESTRICTIONS AS  
REQUIRED BY ACT 288 OF 1967 AS AMENDED  
ON CERTAIN LOTS WITH RESPECT TO THE  
REQUIREMENTS OF THE MICHIGAN DEPARTMENT OF  
NATURAL RESOURCES AND/OR THE MICHIGAN  
DEPARTMENT OF PUBLIC HEALTH, WHICH ARE  
RECORDED IN LIBER 1990 ,PAGES 112-117  
OF RECORDS OF THIS COUNTY.

